

1106

# Witte Road

— SPRING BRANCH —

77055

Delivering 4Q22



## Property Highlights

- Up-to 10,095 SF available
- 1st floor offices + secured parking
- 63% Pre-leased
- Fully redeveloped office building
- Attractive modern finishes
- On-site management
- Adjacent to new retail developments
- Numerous area amenities



# Commercial Office FOR LEASE

FOR LEASING INFORMATION:  
Brad Elmore – 713.408.4000  
be@newfoundpartners.com

# SITE PLAN

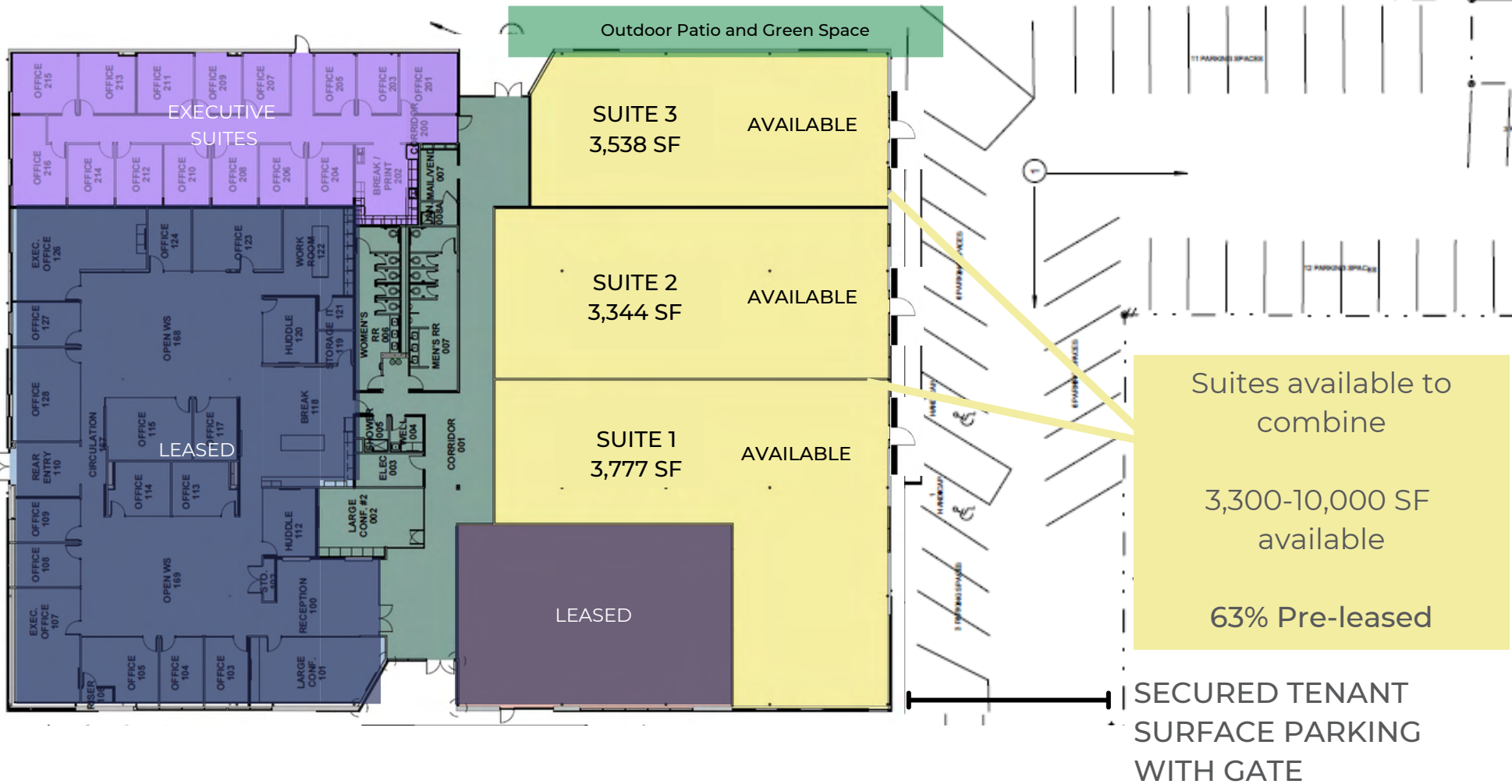

WITTE RD



# LOCATION



Crowbar



Underbelly Burger



Wild Oats



Adjacent Future Retail + Dining

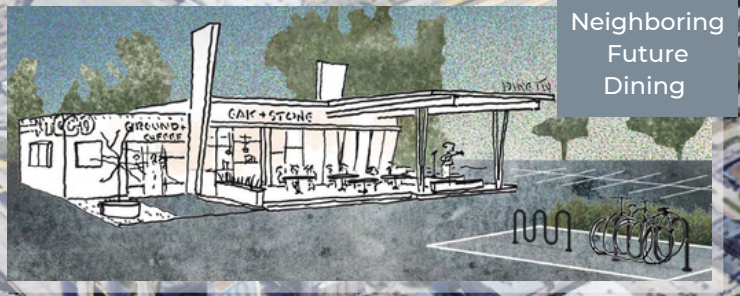

Neighboring Future Dining



CITY CENTRE



# RENDERINGS



FOR LEASING INFORMATION:  
Brad Elmore – 713.408.4000  
be@newfoundpartners.com



# LOCATION

